

# SHUTTLES

Shuttles can be delivered as pneumatic or electronic version. They can be used on the following machine series as standard:

- PP21N/PP150/PP150-IDS
- HVA150, HVA Promotor-4N
- KIPP200
- ALPS-2000

## FEATURES:

Our standard shuttle versions are available with 2 to 6 colours. Electronic shuttles in any length available on request.

## SPECIFICATIONS:

### Pneumatic shuttles

Art #	Application	Colors	Pitch (mm)
DR-114-4	for HVA150, PP150, KIPP200	4	114
DR-150-2S	for PP21N,	2	150
DR-150-2L	for PP150,	2	150
DR-225-2	for PP150, HVA150, KIPP 200	2	225

### Digital shuttles

Art #	Application	Colors	Pitch
DRE-630	for PP150, Promotor-4N	4	variable
DRE-700	for PP150, PP150-IDS, ALPS-2000	6	variable

DR-114-4

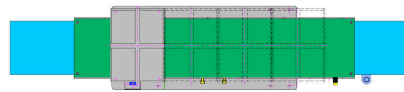

DR-150-2S



DR-150-2L

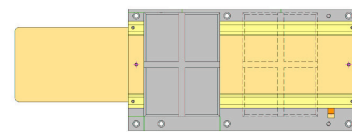

DR-225-2

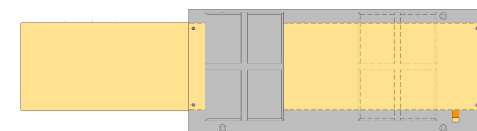

DRE-630



DRE-700



www.kent-stuttgart.de info@kent-stuttgart.de  
Fon: 0711/40950-0 • Fax: 0711/40950-50  
Kesselstraße 46 • 70327 Stuttgart-Wangen